

# The Future is Raised Access Floors



*Building  
to the Power of*



SGS LOGO 485718  
By buying FSC-certified  
products you are promoting  
responsible management of the  
world's forests.  
© 1996 Forest Stewardship Council

# Kingspan Access Floors

# Who we are



**Kingspan Access Floors** is the undisputed leader in raised access floor products, systems and installation. Following Kingspan Group's acquisition of well known brands Hewetson and Tate, Kingspan Access Floors has a forty-year track record, and the name is now inseparable from the concept of flexible, high performance working space.

Modern office automation is dependent on effective Information Technology and communication links which are reliant on the advantages provided by raised access floor systems. These systems facilitate the delivery of power, voice, data and underfloor HVAC, via the underfloor service void, to the precise point of need. This enables rapid office layout changes (churn) and adapts to any future occupier/tenant and technology requirements.

Our success is based on a wide product package, designed to meet any performance and specification requirement, backed with expert support and quality service. Kingspan Access Floors has always aligned itself with quality and value – investing in state of the art manufacturing, high calibre services to deliver installed raised access floors of the highest quality. Buildings worldwide feature raised floors from our comprehensive range.

Kingspan Access Floors is ISO 9001 accredited for both its manufacturing and installation operations. Both operations are backed by unrivalled experience of our technical and support services.

Kingspan is accredited to ISO 14001 however our concerns about the environment do not stop there; considerable investment has been made towards an energy conservation programme at our facility in Hull after assistance from the Carbon Trust. We have a strong focus on recycling waste materials and continually review our environmental policy to ensure we are doing our utmost in protecting the environment.





## The Kingspan Access Floors Service Package

- **Head Office Team**  
Customer Service, Technical Support,  
Manufacturing & Quality Assurance
- **Regional Sales Managers**  
Field-based Technical & Sales Support
- **Installation Services**  
In-house turnkey solutions for all applications
- **Core Works**  
Comprising first build projects and  
major refurbishment
- **On-Line Marketing Services**
  - [www.kingspanaccessfloors.co.uk](http://www.kingspanaccessfloors.co.uk)
  - [www.cheapertobuild.com](http://www.cheapertobuild.com)
  - Literature
  - Product Selector
  - Design & Specification
  - FAQ's

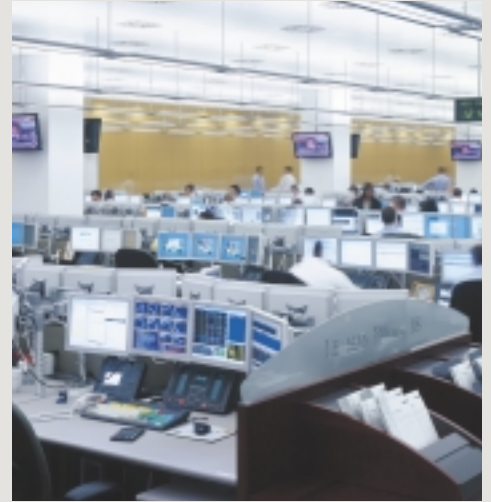

## Access Floor Selection

### WHAT ARE THE APPLICATIONS FOR RAISED ACCESS FLOORS?

Specific individual projects will determine the potential areas in which raised access flooring can be considered. These areas are wide and varied and extend beyond the initial more obvious areas as shown by the following list of application ideas.

Areas in which raised access flooring can be used:

- **General office areas**
- **Meeting rooms**
- **Conference rooms/auditoriums**

Consequently raised access flooring provides cost effective and flexible solutions across a wide range of business sectors either in new build or refurbishment situations.

As a result raised access flooring solutions are frequently used in the following business sectors:-

- **Financial and Insurance offices** where there is a need for a significant level of computer/telecom equipment.

- **National and Local Government offices**, again there is a need for a significant level of computer/telecom equipment.
- **General administration buildings** across the complete range of industries where the use of computer/telecom equipment is widespread.
- **Call Centres**, office environment set up to handle large-scale customer enquires thereby requiring significant levels of computer/telecom equipment.
- **Data processing centres**. Large scale computer rooms set up for the processing of electronic data i.e. customer information, financial information etc.
- **Telecom switch centres**. Old mechanical telephone exchanges now replaced by electronic switch facilities. Also new mobile technology requires new electronic switch facilities.



- **Distribution centres.** These facilities distribute a vast range of fast moving consumer goods with order processing and such activities handled in a modern office environment.
- **Educational facilities.** Raised flooring used in specific learning areas in schools, universities etc. Also used in library and major archive areas.
- **Retail facilities** such as major department stores increasingly use raised floors finished with special finishes.
- **Light industrial** and specialised industries where flexibility and the use of underfloor services would be advantageous.

#### FACTORS THAT INFLUENCE THE RAISED ACCESS FLOORING SPECIFICATION

As the diagram below shows the selection of a raised access flooring product is influenced by many factors including several from outside the obvious areas of application, performance and budget. The actual methods of construction that will be implemented on site are vital factors that must be taken into account as part of the product selection process and subsequent preparation of a project specific raised floor specification.

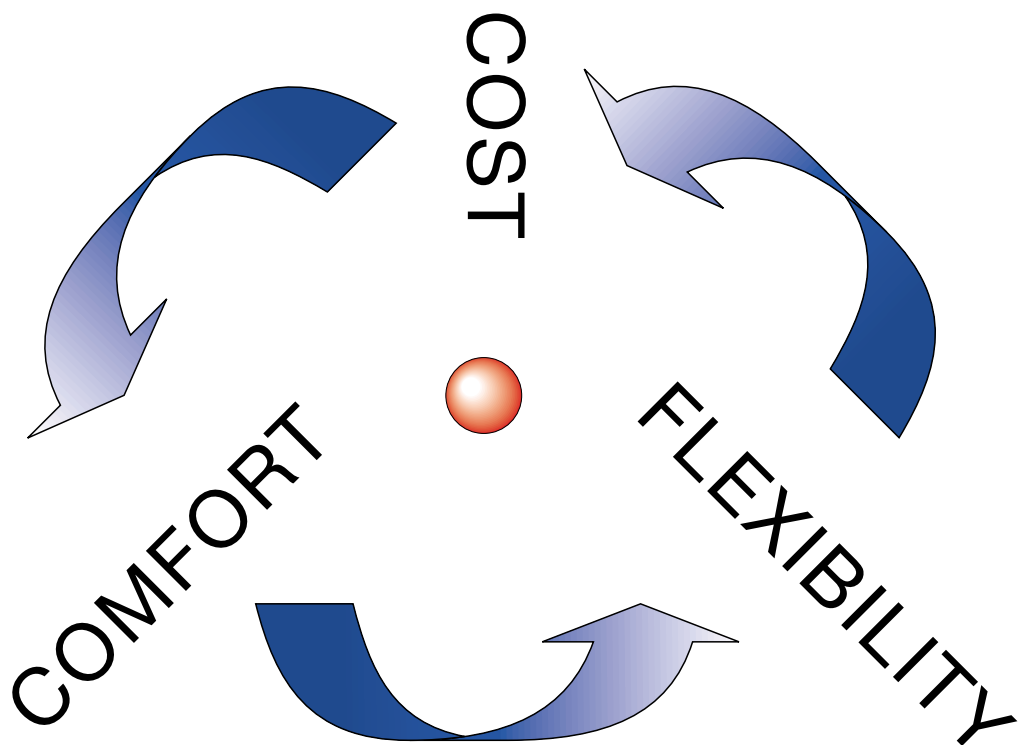

# Kingspan Access Floors provide cable manage

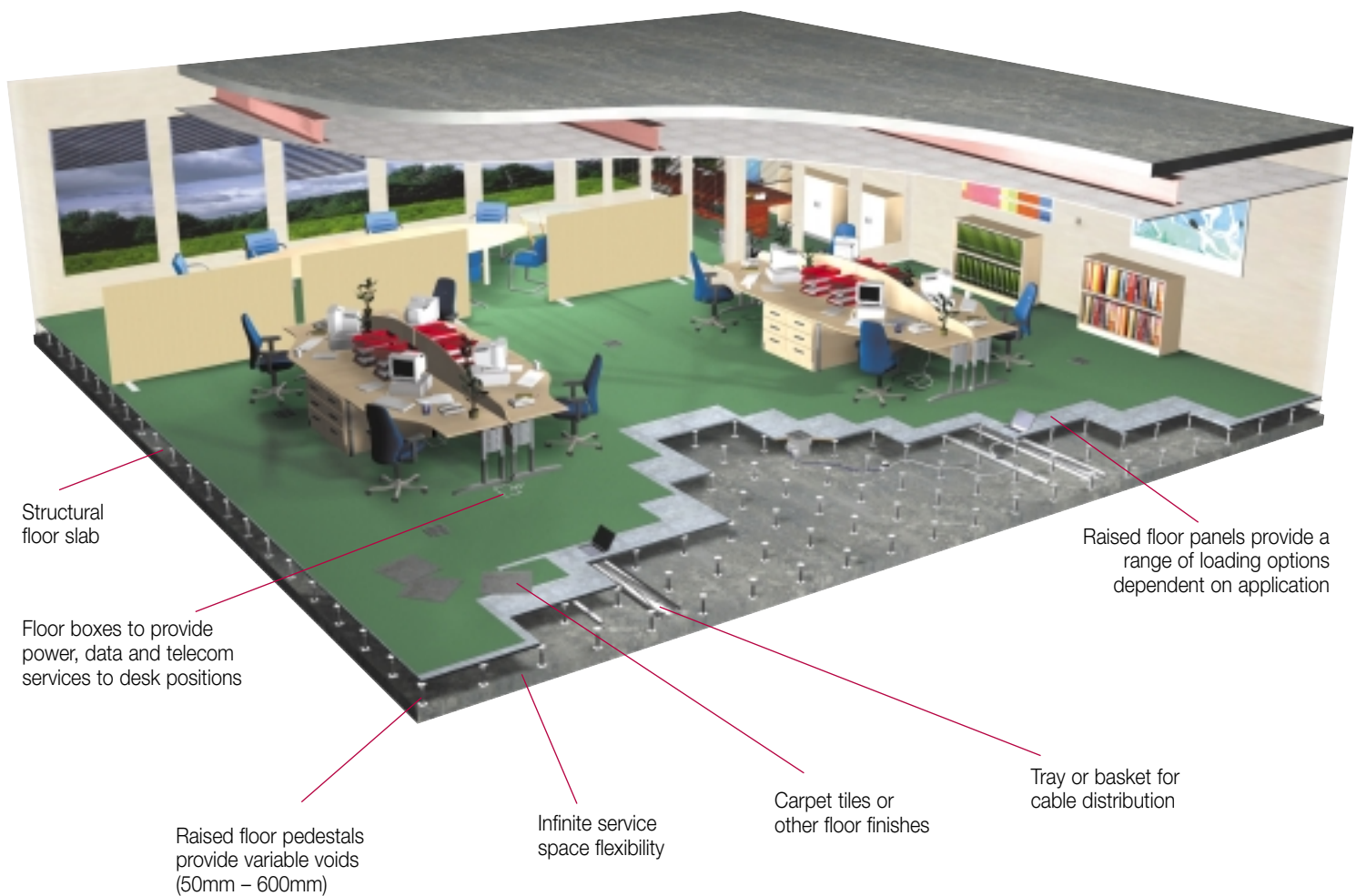

Raised access floors are designed to give maximum flexibility for the installation of a myriad of services to equipment and workstations.

Raised access floors are now used in every new HQ building being built in the UK and also numerous refurbishments of older structures

# ment solution



The modern style of office development based around open plan offices with workstations causes constant changes in desk layout, services etc. which require the initial cable management design to be substantially modified on a regular basis - CHURN.

Every time these distribution systems need to be modified the raised floor offers considerable cost savings, at least 50%!

To alter or amend the services with a raised floor requires the simple lifting of a panel, introduction of the new cables etc. and then replacement of the same panel.

This is virtually impossible with old fashioned cable management systems, such as sub floor trunking, where it is necessary to either scabble the concrete slab or introduce a new piece of trunking before making good the slab.





# The Kingspan Building Technology underfloor

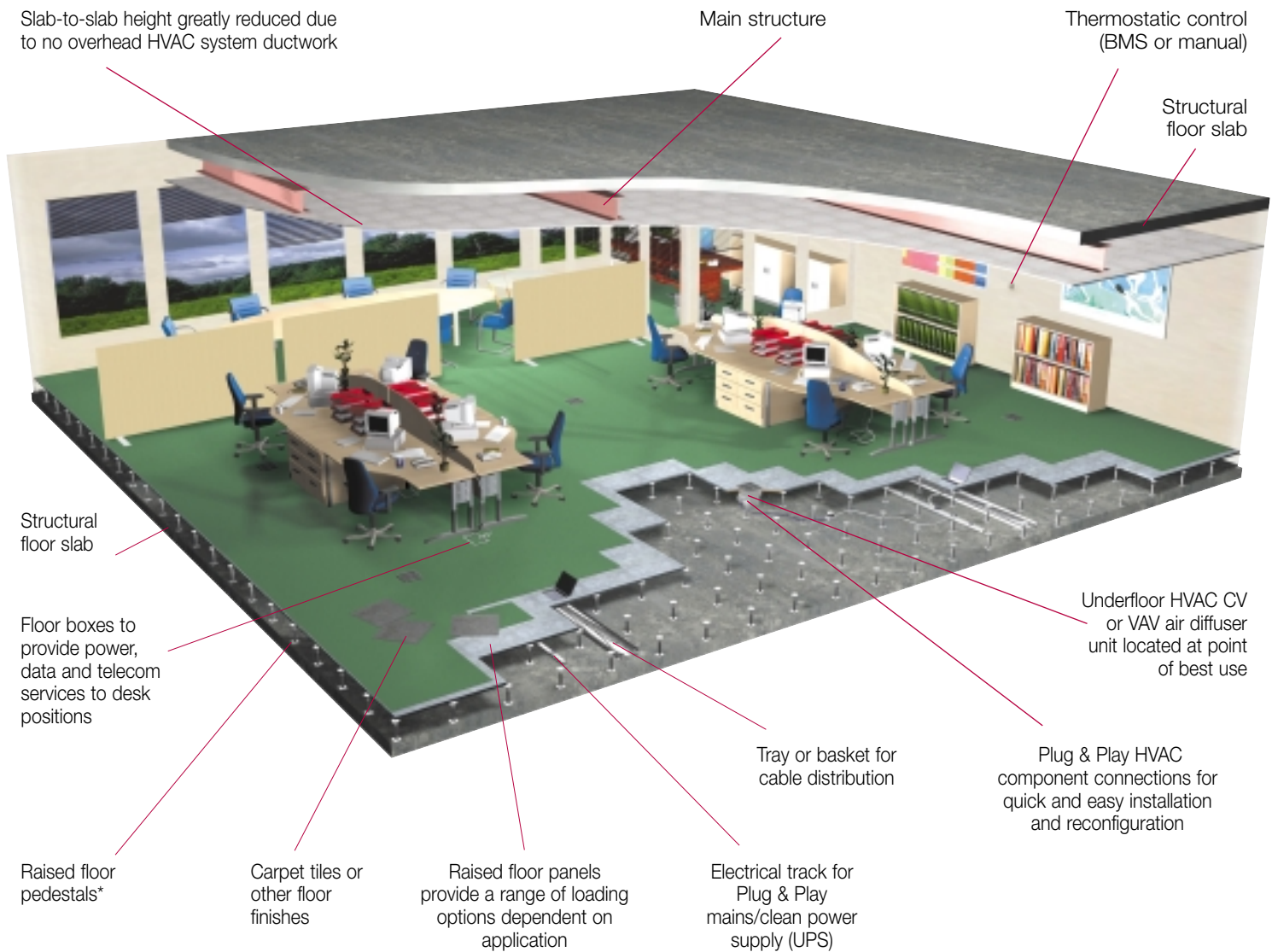

\* Finished floor height (FFH) 150 to 300mm (typical)



# Platform<sup>®</sup>

## HVAC, cable management system

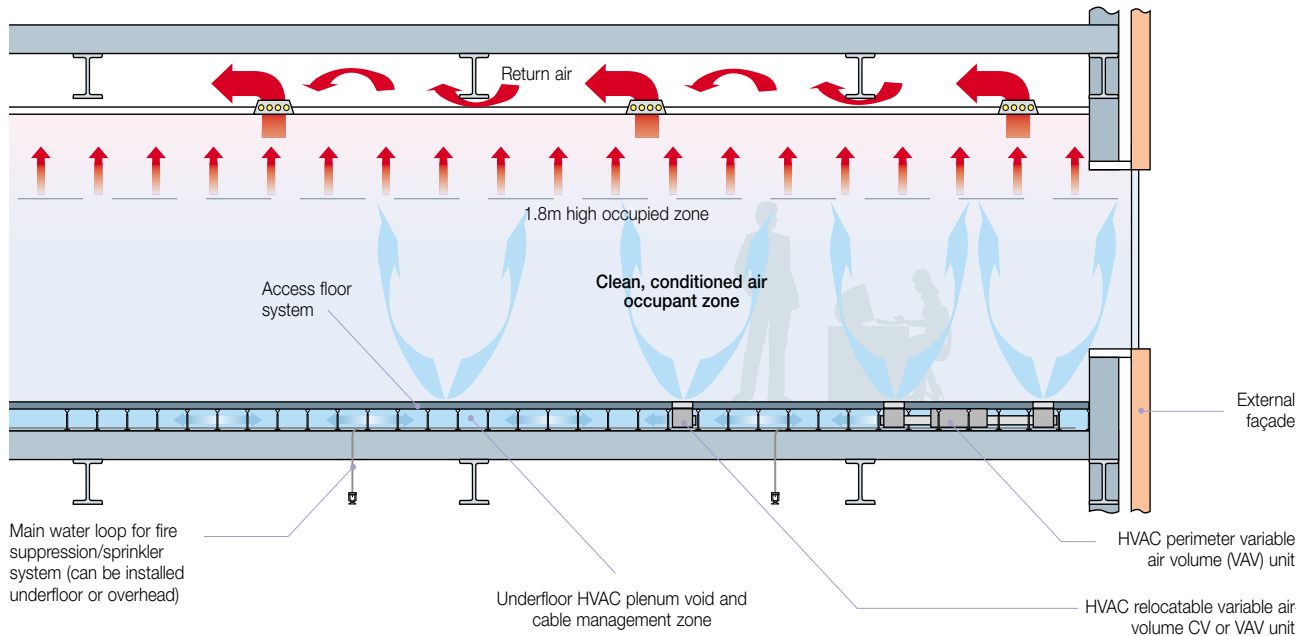

### Cheaper to Build!

#### Property Investor & Developer Benefits

- Reduced initial Capital costs by up to 4%
- Reduced slab to slab height by up to 5% - up to 200mm per floor (equivalent to 1 free floor for tall buildings over 20 floors)
- Reduced HVAC mechanical costs by up to 18%
- Reduced external façade costs by up to 4% per floor
- Reduced main structure, lift shaft and foundation costs
- Increased tenancy opportunity with superior quality, flexible space and lower operating costs
- Enhanced property portfolio value
- Avoids building obsolescence, 'future-proof' space adapts to any technology changes and occupier needs

### Cheaper to Operate!

#### Occupier & Tenant Benefits

- Facilitates rapid office space reconfiguration
- Achieves 27% lower office churn costs per annum
- Saves up to 38% in energy usage
- Saves up to 44% in running costs
- Saves up to 63% in cooling energy consumption
- Saves up to 35% in heating energy consumption

### Cheaper to Staff!

#### Personnel Benefits

- Provides individual temperature control through thermostat or manual controlled diffusers
- Improves air quality to reduce employee absenteeism
- Improves productivity through enhanced working environment
- Reduces risk of Sick Building Syndrome (SBS)

Underfloor HVAC air distribution systems:



# The Kingspan refurbishment solutions

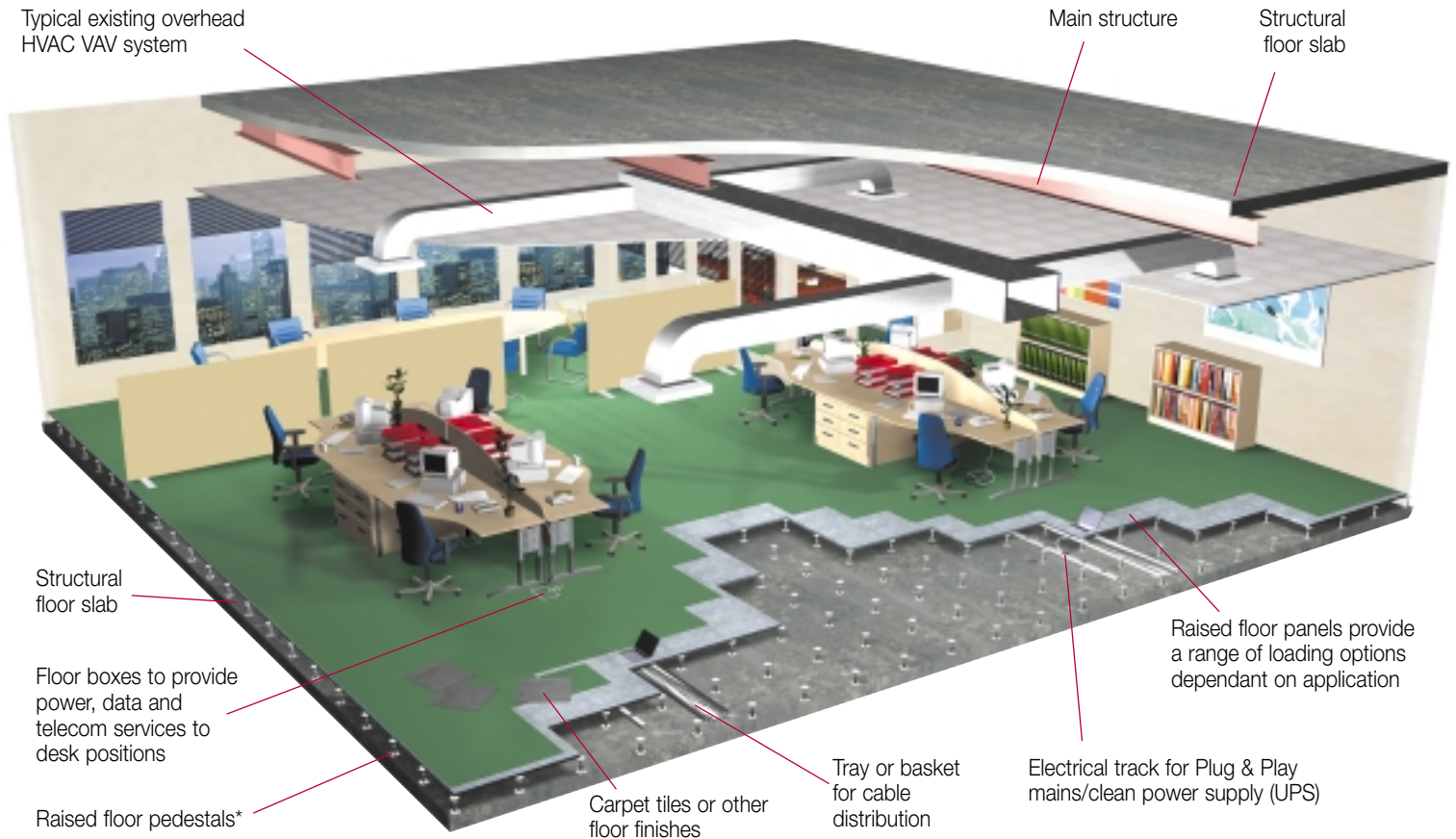

\* **Finished floor height (FFH)** 50 to 150mm (typical)

## Advantages

- Upgrade and refurbish outdated office space to modern office requirements
- Facilitates underfloor cable management and/or underfloor HVAC\*
- Maximises office space layout flexibility to meet occupants and tenants existing and future work space requirements, therefore extending the building's lifecycle
- Eliminates powered furniture costs
- Provides localised desk cable services
- Reduces power, voice and data cabling costs
- Permits rapid office and equipment layout change or upgrading
- Eliminates ceiling cable trays
- Removes cable ceiling to furniture pole systems and improves office environment.
- Faster on-site electrical/data/telecom installation
- Qualifies for 25% accelerated depreciation benefit
- Reduces occupier/tenant operating costs
- Reduces facility and maintenance costs

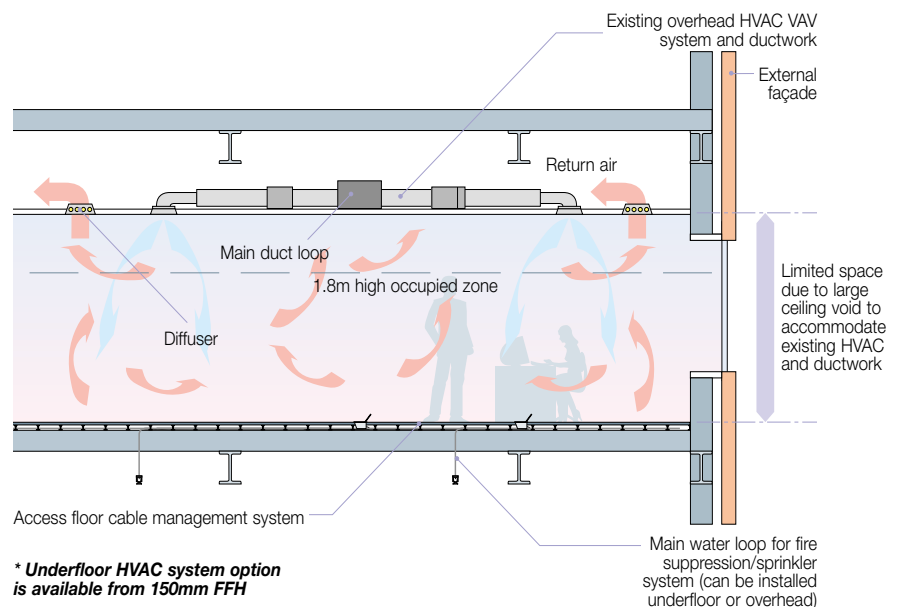



# Kingspan Access Floors provide green design solutions for every sector

'As part of Kingspan's ongoing drive to safeguard the environment, Kingspan Access Floors have extended their environmental policy. They can now ensure that their products are manufactured from environmentally appropriate forest management by recently achieving the FSC's (Forest Stewardship Council) chain of custody standards accreditation.

To ensure that Kingspan met this high standard they approached the FSC for third party accreditation, and in September 2007 received official confirmation from SGS that our procurement and manufacturing processes fully comply with their initiatives.

Going forward every Kingspan delivery note and invoice will identify the materials with FSC accreditation.

Kingspan Access Floors are the world's only access flooring manufacturer that have adopted this standard and have received third party accreditation.'

## Recyclable:

- 100% recyclable materials

## Energy efficient:

- Reduce energy usage by up to 38%, heating energy consumption by up to 35% and cooling energy consumption by up to 63%

## Healthy air quality:

- Reduces risk of Sick Building Syndrome (SBS)
- Increases employee productivity

## Better personnel health:

- Reduced employee absenteeism
- Individualised personal comfort controls

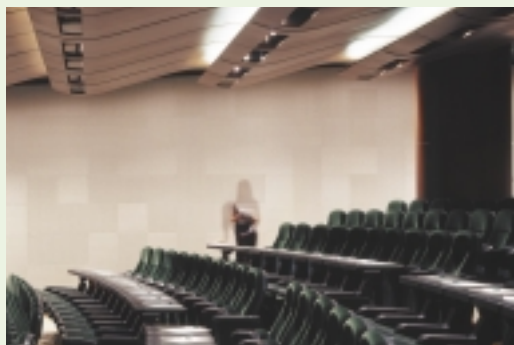
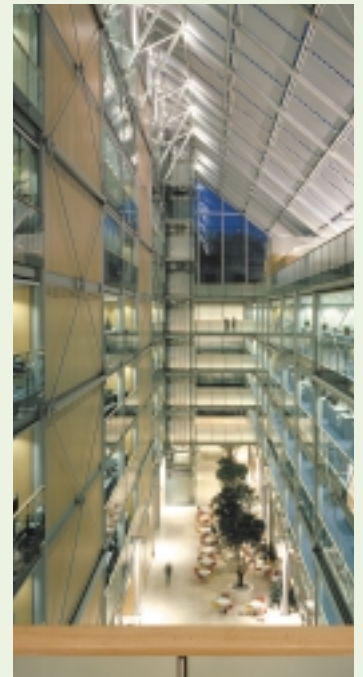

SGS 0000488799  
By buying FSC certified products you are promoting responsible management of the world's forests.  
© 1996 Forest Stewardship Council

# Kingspan Access Floors

panel

Steel encapsulated/particle board construction, loose laid raised access floor panels to the requirements of PSA MOB PF2 PS/SPU and BSEN 12825.

## RG Series Gravity Lay

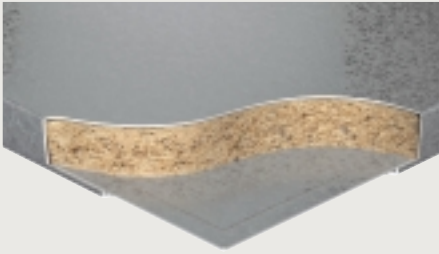

<b>Category</b>	Gravity Lay
<b>Panel Size</b>	600mm square
<b>Core Material</b>	High Density Particle Board
<b>Panel Construction</b>	Galvanised steel encapsulated particle board core

PSA PF2 PS/SPU	Panel Thickness (nominal)	System Weight (typical)
RLG600 light grade	31mm	31kg/m <sup>2</sup>
RMG600 medium grade	31mm	36kg/m <sup>2</sup>
DRF600 heavy grade	32mm	44kg/m <sup>2</sup>
extra heavy grade	32mm	45kg/m <sup>2</sup>

BSEN	Panel Thickness (nominal)	System Weight (typical)
RG3	31mm	31kg/m <sup>2</sup>
RG5	31mm	36kg/m <sup>2</sup>
RG6	32mm	44kg/m <sup>2</sup>

Steel encapsulated/particle board construction, screw down raised access floor panels to the requirements of PSA MOB PF2 PS/SPU and BSEN 12825.

## TorLock Screw Down

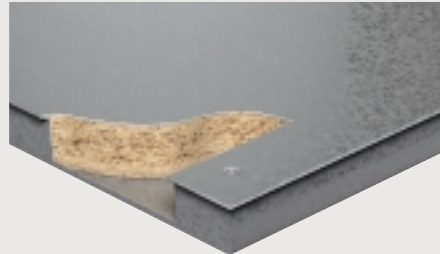

<b>Category</b>	Screw Down
<b>Panel Size</b>	600mm square
<b>Core Material</b>	High Density Particle Board
<b>Panel Construction</b>	Galvanised steel encapsulated particle board core

PSA PF2 PS/SPU	Panel Thickness (nominal)	System Weight (typical)
TorLock medium grade	26mm	32kg/m <sup>2</sup>

BSEN	Panel Thickness (nominal)	System Weight (typical)
TL3	26mm	30kg/m <sup>2</sup>
TL5	26mm	32kg/m <sup>2</sup>

Raised access floor panels complete with factory applied vinyl, linoleum, HPL, or rubber to the requirements of PSA MOB PF2 PS/SPU and BSEN 12825.

## FDeb Series Full Depth Edge Banded

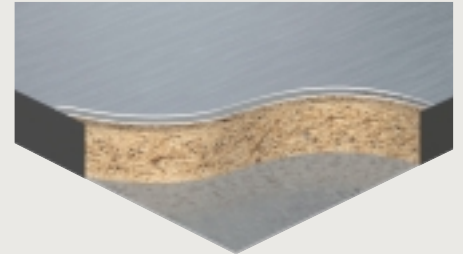

<b>Category</b>	Gravity Lay
<b>Panel Size</b>	600mm square
<b>Core Material</b>	High Density Particle Board
<b>Panel Construction</b>	Galvanised steel sheet bonded to core with edge banding

PSA PF2 PS/SPU	Panel Thickness (nominal) <small>Exc. covering</small>	System Weight (typical)
FDEB 30 medium grade	31mm	42kg/m <sup>2</sup>
FDEB 38 heavy grade	39mm	52kg/m <sup>2</sup>
extra heavy grade	39mm	53kg/m <sup>2</sup>

BSEN	Panel Thickness (nominal) <small>Exc. covering</small>	System Weight (typical)
FDEB 1	31mm	30kg/m <sup>2</sup>
FDEB 4	31mm	37kg/m <sup>2</sup>
FDEB 6	39mm	52kg/m <sup>2</sup>



# options

Steel encapsulated/particle board construction, loose lay raised access floor panels to the requirements of PSA MOB PF2 PS/SPU and BSEN 12825.

## Diamond Gravity Lay

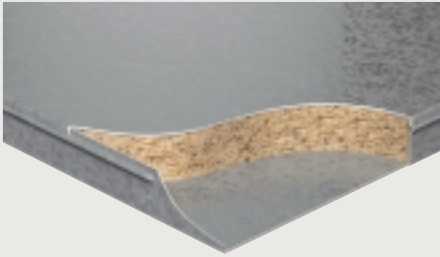

<b>Category</b>	Gravity Lay
<b>Panel Size</b>	600mm square
<b>Core Material</b>	High Density Particle Board
<b>Panel Construction</b>	Galvanised steel encapsulated particle board core

PSA PF2 PS/SPU	Panel Thickness (nominal)	System Weight (typical)
<b>Diamond</b> medium grade	31mm	36kg/m <sup>2</sup>

BSEN	Panel Thickness (nominal)	System Weight (typical)
<b>D3</b>	31mm	31kg/m <sup>2</sup>
<b>D5</b>	31mm	36kg/m <sup>2</sup>

Particle board construction, lock down raised access floor panels to the requirements of BSEN 12825.

## D-Lock Lock Down

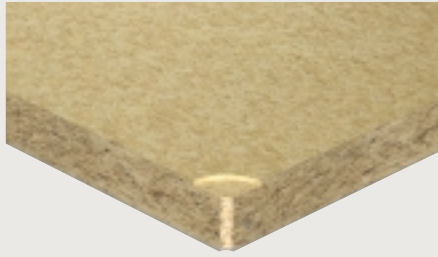

<b>Category</b>	Lock Down
<b>Panel Size</b>	600mm square
<b>Core Material</b>	High Density Particle Board
<b>Panel Construction</b>	Machined particle board that includes lock down provision

PSA PF2 PS/SPU	Panel Thickness (nominal)	System Weight (typical)
-------------------	---------------------------------	-------------------------------

BSEN	Panel Thickness (nominal)	System Weight (typical)
<b>D-Lock 30</b>	30mm	26kg/m <sup>2</sup>
<b>D-Lock 38</b>	38mm	31kg/m <sup>2</sup>

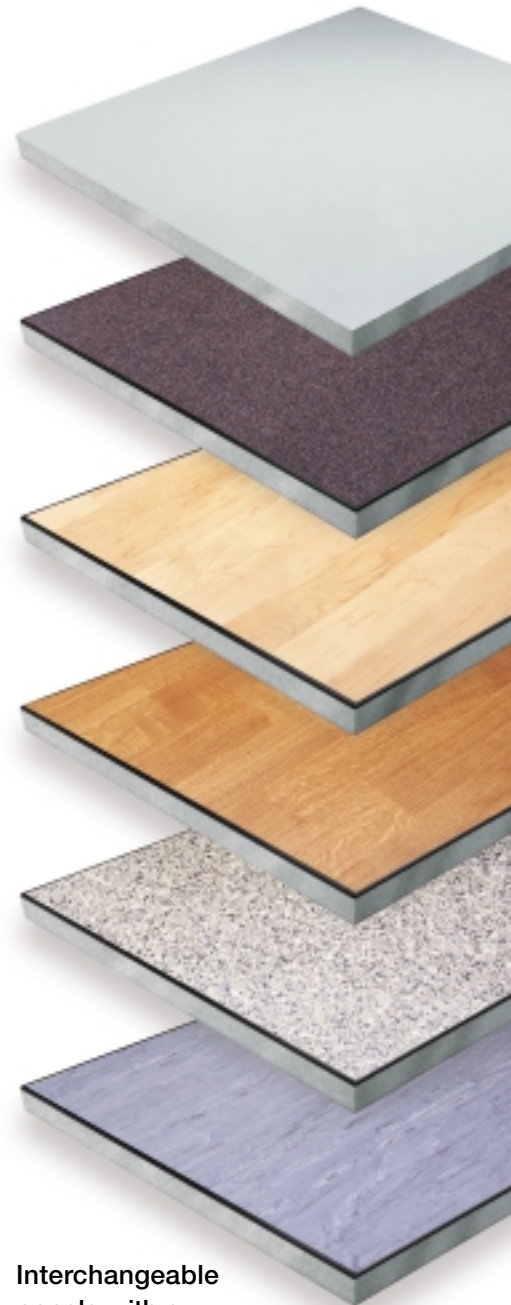

Interchangeable  
panels with a  
variety of surfaces

# Kingspan Access Floors

## pedestal options

### Steel Encapsulated Particle Board Support Systems

EuroPed II



Alpha V



Alpha III

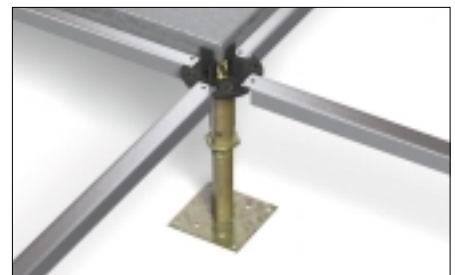
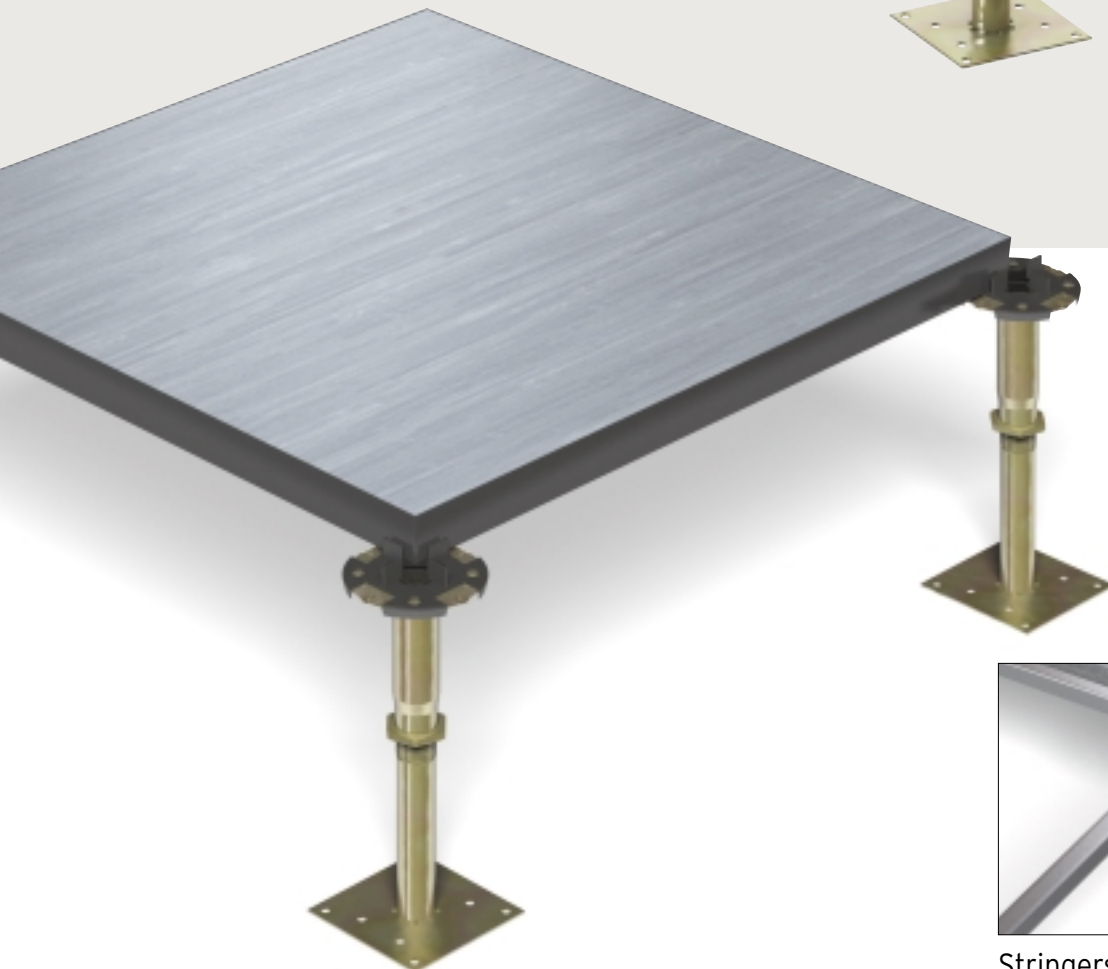

Stringers

Used for lateral stability.



# Kingspan Access Floors

## floor finish solutions

Kingspan Access Floors can accommodate any variety of floor finishes, including floor carpet tiles, laminates and natural material finishes. Typically the majority of offices require anti-static carpet tiles in general office and corridor areas, whereas natural finishes are used within public/lobby areas.

### Natural materials

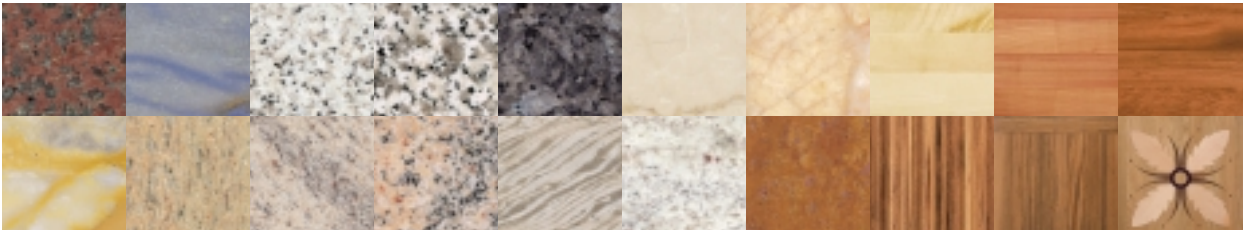

The use of natural materials promotes a prestigious image and interior environment which many occupiers and tenants demand.

Kingspan Access Floors has a wide range of high quality, unique Natural Finishes allowing creative flooring freedom, including:

- Decorative granite, marble and natural stone finished raised floor panels
- Decorative overlay granite, marble and natural stone panels to allow the application of these finishes to an existing raised floor installation
- Decorative natural wood finished raised floor panels

For further details on the full range of natural finishes contact Kingspan Access Floors and request the Natural Finishes brochure.

**Note:** Colour variations and markings are characteristics of natural materials. Inherent variation cannot be controlled nor the precise shade of product supplied guaranteed. Precise colour should be judged from the actual material. All natural finishes are subject to availability.

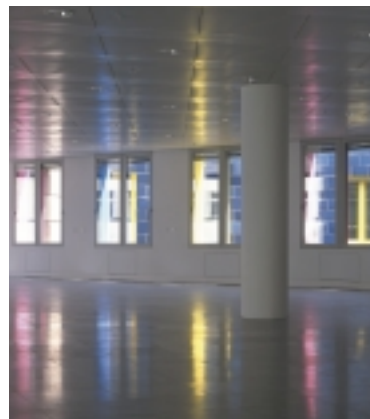



**Kingspan Access Floors Limited**

Head Office: Burma Drive, Marfleet, Hull HU9 5SG  
tel: +44 (0) 1482 781701 fax: +44 (0) 1482 799272

visit our website: [www.kingspanaccessfloors.co.uk](http://www.kingspanaccessfloors.co.uk)  
or our group website [www.kingspan.com](http://www.kingspan.com)